



**CHARTRIDGE**  
CONFERENCE COMPANY

## HITCHIN PRIORY - ROOM DIMENSIONS

<b>Conference, Syndicate &amp; Private Dining</b>	<b>Dimensions L x W x H Feet</b>	<b>Dimensions L x W x H Metres</b>	<b>Theatre</b>	<b>U-Shape</b>	<b>Board</b>	<b>Cabaret</b>	<b>Dining</b>
Adam Room	33x22x14	10x6.7x4.2	75	25	26	20	60
Library	23x17	7x5.1	30	12	16	-	12
Picture Gallery	23x14	7x4.2	25	10	12	-	12
Lady Julia's	34x22x12	10x6.7x3.6	80	28	30	32	-
Music Room	40x23x12	12x7x3.6	90	26	32	54	-
Ann Radcliffe's	34x21x11	10x6.7x3.6	70	25	26	25	-
Sir Ralph's	23x18	7x5.4	-	10	16	-	-
Roger Ascham's	22x11	6.7x3.3	20	12	12	-	-
Carmelite	14x12	4.2x3.6	-	-	6	-	-
Brother Alexander's	16x10	4.8x3	-	-	10	-	-
Prior Butler's	16x10	4.8x3	-	-	10	-	-
Lady Emily's	37x20x12	11x6x3.6	65	26	28	32	-
Syndicate 1	18x10x10	5.4x3x3	-	-	6	-	-
Linnet Room	26x20	7.9x6	50	15	16	18	-
Syndicate 2	20x10x10	6x3x3	-	-	6	-	-
Radcliffe	30x19x11	10x6x3	40	12	20	-	40
Delme	40x23x12	13x7x4	60	-	-	-	70

### Hitchin Priory

Tilehouse Street, Hitchin, Hertfordshire SG5 2DL

Tel: 01462 420500

Fax: 01462 422101

Email: [priory@chartridge.co.uk](mailto:priory@chartridge.co.uk)



CHARTRIDGE  
CONFERENCE COMPANY

## HITCHIN PRIORY - ROOM MAP

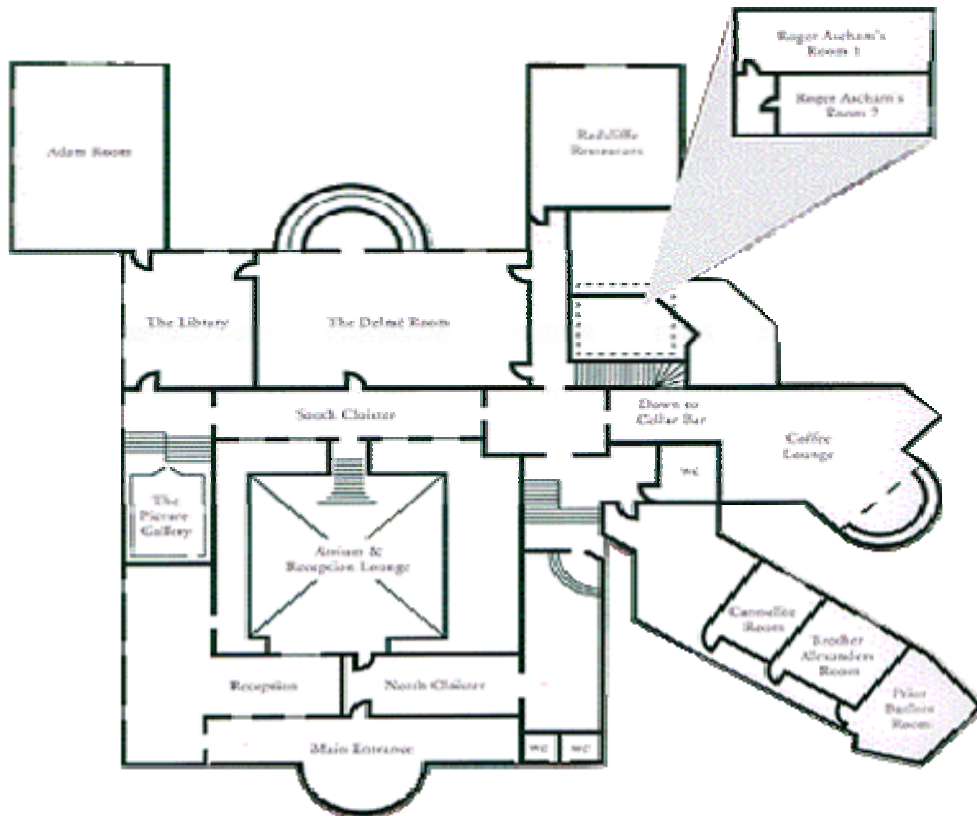

### FIRST FLOOR



### Hitchin Priory

Tilehouse Street, Hitchin, Hertfordshire SG5 2DL

Tel: 01462 420500

Fax: 01462 422101

Email: [priory@chartridge.co.uk](mailto:priory@chartridge.co.uk)



CHARTRIDGE  
CONFERENCE COMPANY

MEWS



**Hitchin Priory**

Tilehouse Street, Hitchin, Hertfordshire SG5 2DL

Tel: 01462 420500

Fax: 01462 422101

Email: [priory@chartridge.co.uk](mailto:priory@chartridge.co.uk)